



RIPSTIK ELECTRIC REAR WHEEL REPAIR KIT INSTRUCTIONS

Kit Includes:

W15155040132

- A. Phillips screwdriver
- B. 13 mm wrench
- C. Spacer and lock washers (See Page 2 • Step 6 • Part 1-5)

⚠WARNING

⚠CAUTION: To avoid potential shock or other injury, turn power switch **OFF** and disconnect charger before removing or installing the rear wheel. Failure to follow these steps in the correct order may cause irreparable damage.

Step 1

Carefully flip unit over. Loosen the four (4) Phillips screws on the rear cover.

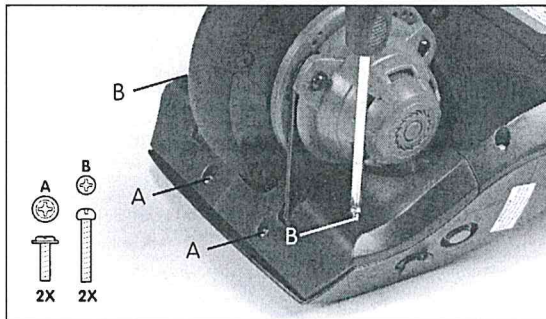

Step 2

Remove cover.

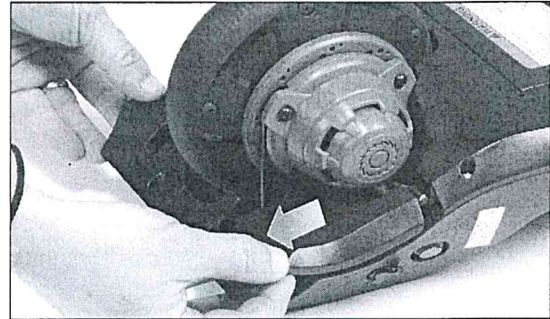

Step 3

Loosen the 13 mm axle nut (1-1) on the rear wheel and remove axle nut; lock washer (1-2) and flat washer (1-3). (See page 2, step 6.)

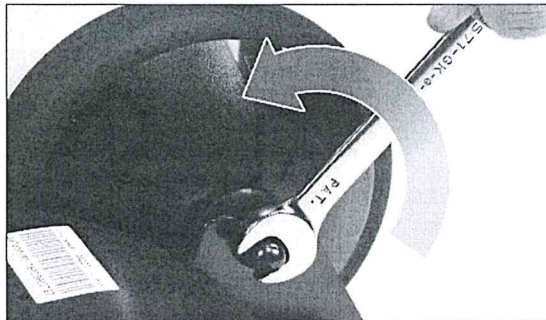

Step 4

Remove the three (3) Phillips screws on the motor housing.



Need Help? Visit our website at www.razor.com or call 01189 736222 Monday - Thursday 9:00 AM - 5:30 PM, Friday 9:00 AM - 3:00 PM.

For instructional video on YouTube please visit our channel Recreation Ltd

Step 5

Locate the white plastic connector attached to the blue and yellow wires and disconnect connectors. (Note lock washer (1-2) and locknut (1-4) located on the inside of frame.)

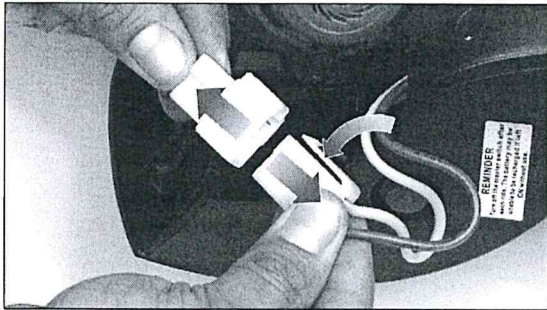

Step 6

Remove the wheel from the frame. Install the spacer (1-5) provided in the repair kit; locknut (1-4) and new lock washer (1-2) onto the axle bolt.

(1-1) Axle Nut
(1-2) Lock Washer
(1-3) Flat Washer
Frame
(1-2) Lock Washer
(1-4) Locknut
(1-5) Spacer

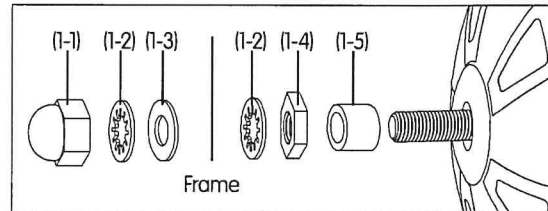

Step 7

Reinstall rear wheel with motor connector closest to the frame. Install flat washer (1-3), lock washer (1-2) and axle nut (1-1). Align the holes on the motor housing with the holes on the motor and frame. Secure in place using the three (3) screws removed in Step 4.

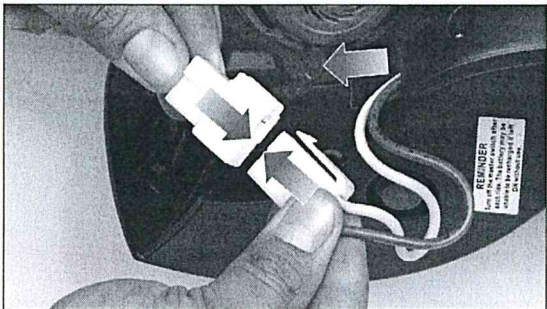

Step 8

Tighten axle nut until rear wheel is securely in place.

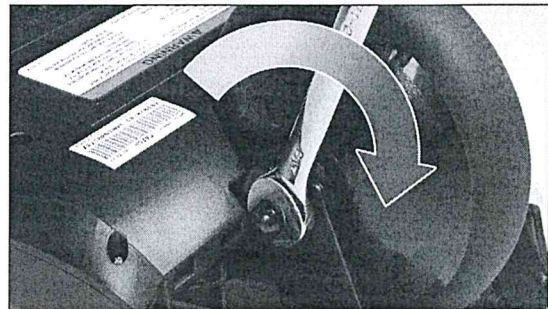

170421

Need Help? Visit our website at www.razor.com or call 01189 736222 Monday-Thursday 9:00AM - 5:30 PM, Friday 9:00 AM - 3:00 PM.

For instructional video on YouTube please visit our channel Recreation Ltd